

What is CEISS?

The Centre of Excellence for Integrated Seniors' Services (CEISS) is a model in the provision of integrated services for an improved continuum of seniors' healthcare.

Phase 1 was the construction of Sister Leila Greco Apartments, a 132-unit supportive housing building which is now complete and fully occupied.

Phase 2 is the expansion of 416 long-term care beds in a seven-storey building adjacent to Hogarth Riverview Manor. Completion date: November 2015.

Phase 3 will be the addition of 32 long-term care beds to the existing Hogarth Riverview Manor home (an addition of eight beds per each of the four units). Completion date: June 2016.

CEISS is not just a physical centre or space. It is the creation of a full spectrum of quality healthcare for seniors, through the integration of many services.

As we improve the physical environment at HRM over the next two years, St. Joseph's Care Group will continue to provide excellence in seniors' care.

Questions? Email us at hrmfeedback@tbh.net

St. Joseph's Care Group

Corporate Office

St. Joseph's Hospital
35 Algoma St. N.
Thunder Bay, ON P7B 5G7
(807) 343-2431

www.sjcg.net
communications@tbh.net

Mission

St. Joseph's Care Group is a Catholic organization that identifies and responds to the unmet needs of the people of Northwestern Ontario, as a way of continuing the healing mission of Jesus in the tradition of the Sisters of St. Joseph of Sault Ste. Marie.

Vision

A leader in client-centred care.

*Care
Compassion
Commitment*



Hogarth Riverview Manor Expansion: *Building Excellence*



*Care
Compassion
Commitment*

Cette information est disponible en français sur demande.

HRM Expansion

Located on Lillie Street North, Hogarth Riverview Manor (HRM) opened in 2004. It currently has 96 long-term care beds.

The HRM Expansion is a seven-story building under construction beside Hogarth Riverview Manor. It will add 416 long-term care beds to the original home.

Features:

- ◆ Individual rooms
- ◆ Fresh meals prepared on site
- ◆ Life enrichment programs
- ◆ Chapel, with services provided
- ◆ Green space and gardens

Resident Amenities

The HRM Expansion will have 13 resident home areas with 32 rooms each.

All residents will have their own room for maximum privacy. Telephone, cable television and computer connections are available in each room.

Residents, families and visitors have access to larger communal activity areas, both within the Resident Home Area and more central community spaces in the building. These areas can host a variety of social functions for large groups.

The social, psychological and physical therapeutic benefits of indoor greenery and outdoor spaces will be maximized.

Questions? Email us at hmrfeedback@tbh.net

The Link

The HRM Expansion will connect to the Sister Leila Greco Apartments via *The Link*, a community hub with the following services:

- ◆ Hairdressing Shop
- ◆ Convenience Store and Café
- ◆ Physicians & Pharmacy
- ◆ Physiotherapy & other Healthcare Services
- ◆ Volunteer and Auxiliary Services

Room Design

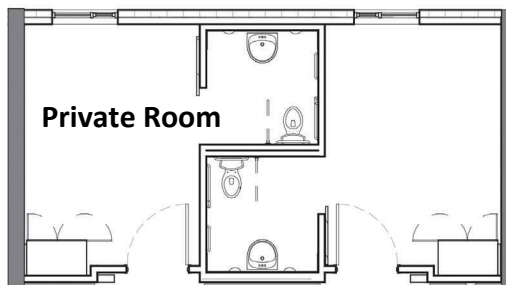

Private rooms are 155 square feet and include a bed, bedside table, wardrobe, comfortable chair and window. These rooms feature a private washroom.

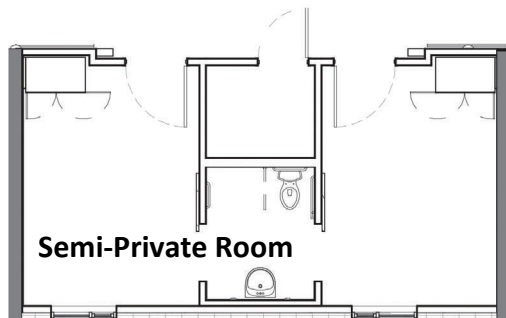

Semi-private rooms are identical to private rooms in size and set-up; however, one washroom is shared between two residents.

Client-Centred Care

St. Joseph's Care Group provides long-term care services in a home-like setting where each resident's individuality is supported with respect and dignity.

Our fully-qualified staff are committed to providing compassionate, client-centred care in a warm, welcoming environment.

Residents and their family members are encouraged to participate in decisions made about their care, with the ultimate goal of achieving the highest level of independence and self-care possible.



“The expansion to Hogarth Riverview Manor will provide a modernized home-like environment for all of our residents, their families, our staff and volunteers.”

*Tracy Buckler
President & CEO*

Questions? Email us at hmrfeedback@tbh.net